

Room Schedule - Adjacent Domestic Terminal 01

Area	Comments
01 AIRLINE LOUNGE	
AIRLINE LOUNGE LOBBY	100.44 m <sup>2</sup>
AMENITIES	
RESTROOM	415.50 m <sup>2</sup> HEADHOUSE
RESTROOM	156.16 m <sup>2</sup> PIER A1
RESTROOM	150.32 m <sup>2</sup> PIER A1
BoH	
BoH	166.12 m <sup>2</sup>
STAFF ACCOMMODATION	358.17 m <sup>2</sup> POTENTIAL LOCATION
STAFF ACCOMMODATION	659.75 m <sup>2</sup> POTENTIAL LOCATION
BoH	67.47 m <sup>2</sup>
CIRCULATION	
LANDSIDE CIRCULATION	528.42 m <sup>2</sup>
AIRSIDE CIRCULATION	310.54 m <sup>2</sup>
AIRSIDE CIRCULATION	3421.80 m <sup>2</sup>
BRIDGE TO INTERNATIONAL TERMINAL SECURITY	89.70 m <sup>2</sup>
BRIDGE TO GATES	246.70 m <sup>2</sup>
FLB	88.60 m <sup>2</sup>
FLB	88.60 m <sup>2</sup>
FLB	84.37 m <sup>2</sup>
FLB	83.90 m <sup>2</sup>
FLB	140.77 m <sup>2</sup>
FLB	83.90 m <sup>2</sup>
FLB	83.90 m <sup>2</sup>
FLB	83.90 m <sup>2</sup>
FLB	83.90 m <sup>2</sup>
FLB	390.06 m <sup>2</sup>
FLB	155.38 m <sup>2</sup>
GATE LOUNGE	
GATE LOUNGE DOM PIER	218.10 m <sup>2</sup>
GATE LOUNGE DOM PIER	410.26 m <sup>2</sup>
GATE LOUNGE DOM PIER	675.50 m <sup>2</sup>
GATE LOUNGE DOM PIER	1283.14 m <sup>2</sup>
BOARDING GATE	93.67 m <sup>2</sup>
RETAIL	
DOM RETAIL AIRSIDE	537.83 m <sup>2</sup>
DOM RETAIL AIRSIDE	1064.74 m <sup>2</sup>
DOM RETAIL AIRSIDE	381.06 m <sup>2</sup>
DOM RETAIL AIRSIDE	226.82 m <sup>2</sup>
DOM RETAIL AIRSIDE	298.46 m <sup>2</sup> PIER A1
SECURITY	
DOM SECURITY	1482.98 m <sup>2</sup> 5 LANES

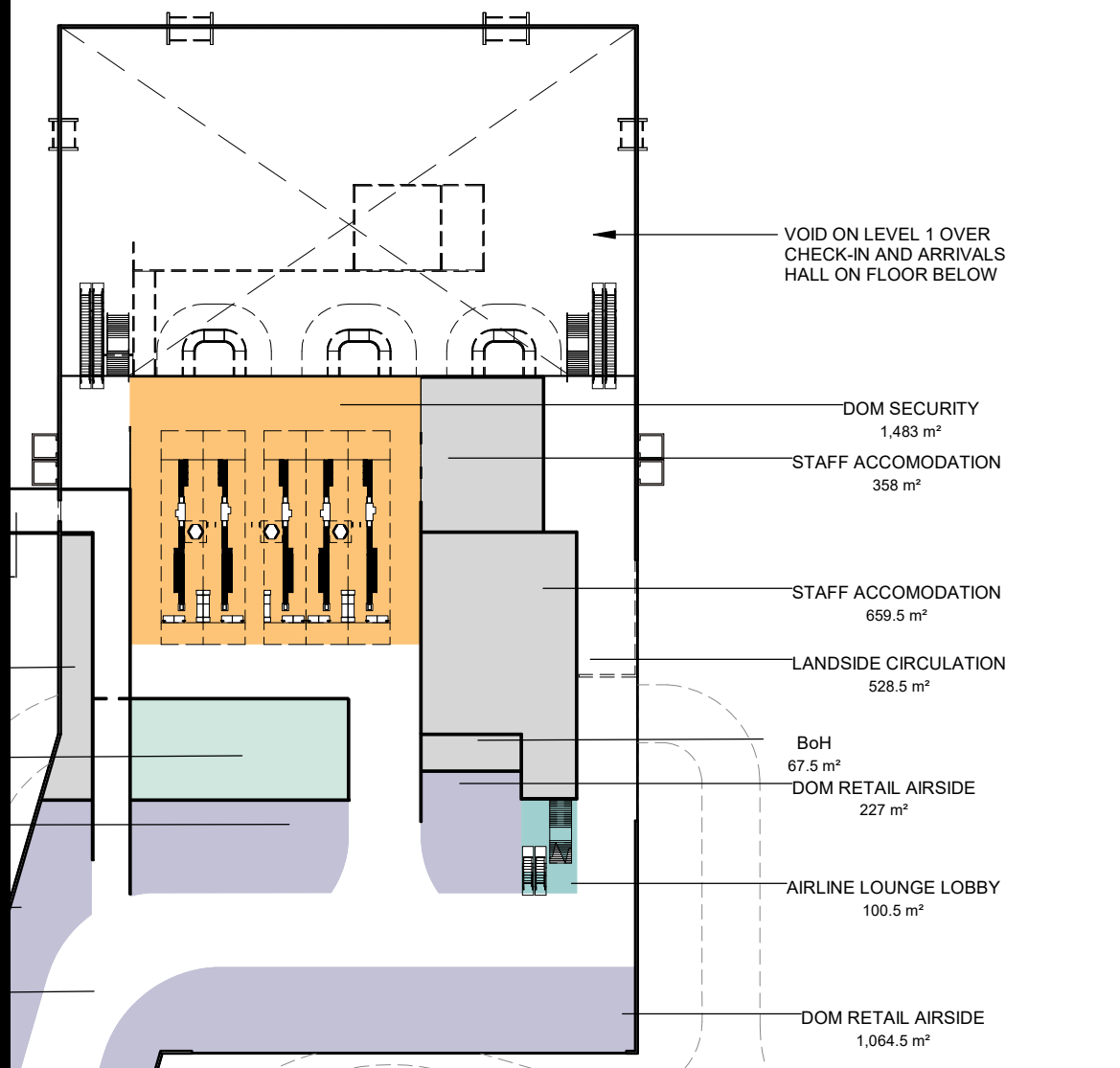

VOID ON LEVEL 1 OVER CHECK-IN AND ARRIVALS HALL ON FLOOR BELOW

DOM SECURITY 1482.98 m<sup>2</sup>

STAFF ACCOMMODATION 358.17 m<sup>2</sup>

STAFF ACCOMMODATION 659.75 m<sup>2</sup>

LANDSIDE CIRCULATION 528.42 m<sup>2</sup>

BoH 166.12 m<sup>2</sup>

DOM RETAIL AIRSIDE 227 m<sup>2</sup>

AIRLINE LOUNGE LOBBY 100.44 m<sup>2</sup>

DOM RETAIL AIRSIDE 1064.74 m<sup>2</sup>

- LEGEND
- CHECK-IN
  - RETAIL
  - GENERAL SEATING
  - CIRCULATION
  - AIRLINE LOUNGE
  - AMENITIES
  - SECURITY
  - GATE LOUNGE
  - ARRIVALS
  - BHS
  - BoH

Issue Date

**ARUP**

Human Koroit Building Level 215 Gateway Street, Auckland CBD, Auckland 1010  
www.arup.com

Client  
**Air New Zealand**

Project Title  
**DOMESTIC TERMINAL - Alternate Pathways : Phase 3**  
Ray Emery Drive, Auckland

Key Plan

Drawing Title

Scale of A0 1 : 1000

Role

Status

Arup Job No  
**293866-04**

File

**ARUP-A11101**



Room Schedule - Adjacent Domestic Terminal 02		
vv	Area	Comments
02	AIRLINE LOUNGE	
	AIRLINE LOUNGE	3133.69 m <sup>2</sup> DOMESTIC
	BoH	
	MEP	1600.71 m <sup>2</sup>

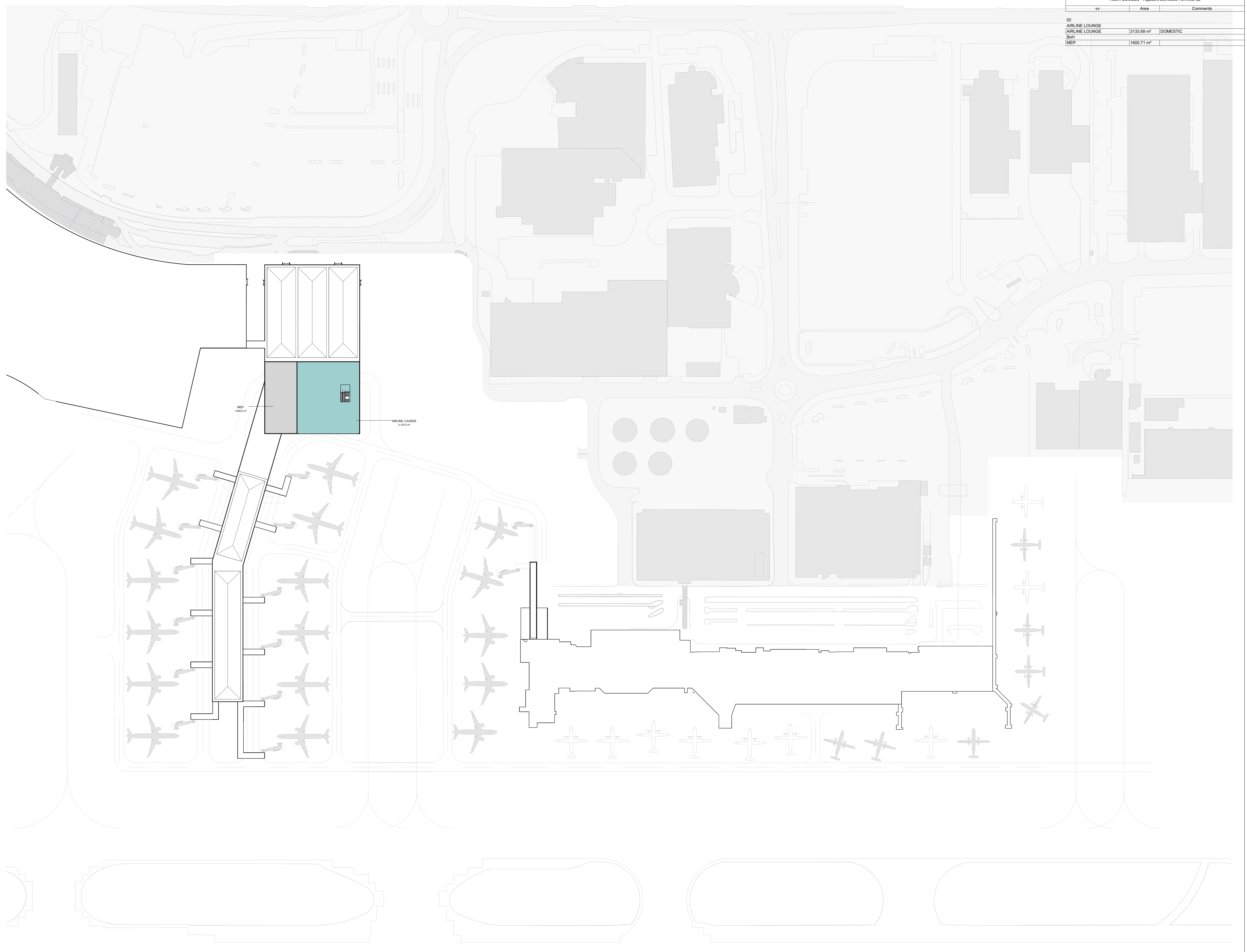

- LEGEND
- CHECK-IN
  - RETAIL
  - GENERAL SEATING
  - CIRCULATION
  - AIRLINE LOUNGE
  - AMENITIES
  - SECURITY
  - GATE LOUNGE
  - ARRIVALS
  - BHS
  - BoH

Issue	Date



Human Kōwhiri Building Level 2/15 Gateway Street, Auckland CBD, Auckland 1010  
www.arup.com

Client  
**Air New Zealand**

Project Title  
**DOMESTIC TERMINAL - Alternate Pathways - Phase 3**  
Ray Emery Drive, Auckland

Key Plan

Drawing Title

Scale of A0 1 : 1000  
 Designer/Author/Checker/Approver

Date

Status

Arup Job No. **293866-04** Rev

ID

**ARUP-A11102**